

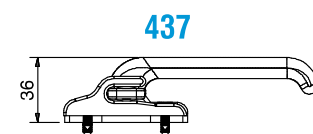
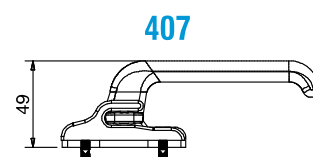
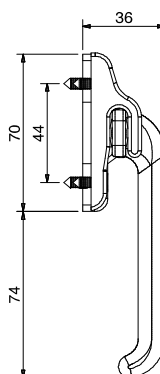
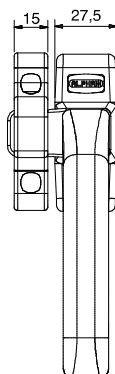
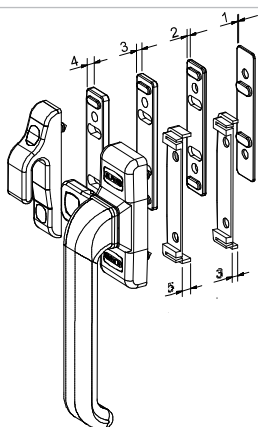
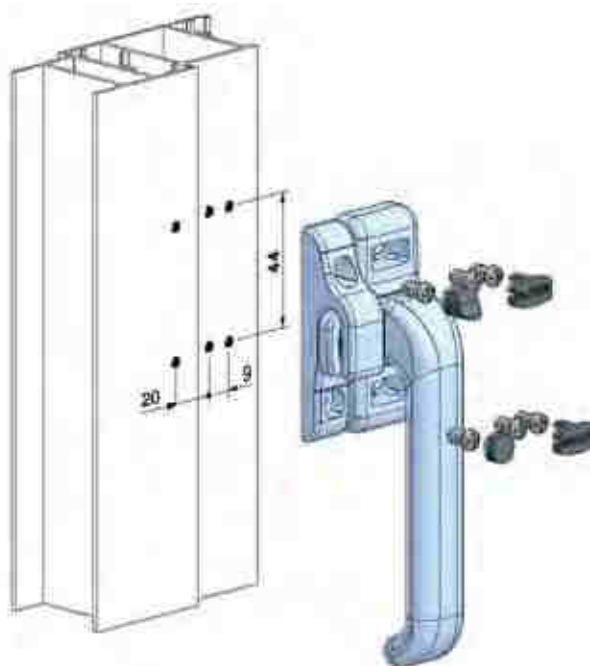
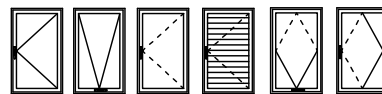

ALPHA

Mod. Dep.

**EMBALAGEM**

Caja com 10 unidades. 2465 grs.

**MATERIALS**

Alumínio e zamak

**FIXAÇÃO**

Parafusos incluídos

**ACABAMENTO**

Lacado

**NORMAS**

EN 1670

**OBSERVAÇÕES**

Fixação frontal. Calços de nylon com 1mm, 2mm, 3mm e 4mm (inc.)

**PACKAGING**

Box with 10 units. 2465 grs.

**MATERIALS**

Aluminium and zamak

**FIXING**

Screws included

**FINISHING**

Powder painting

**STANDARD**

EN 1670

**COMMENTS**

Frontal fixation. Nylon alignment elements with 1mm, 2mm, 3mm e 4mm (inc.)

**EMPAQUETADO**

Caja con 10 unidades. 2465 grs.

**MATERIALES**

Aluminio y zamak

**FIJACIÓN**

Tornillos incluidos

**ACABADOS**

Lacado

**NORMAS**

EN 1670

**OBSERVACIONES**

Fijación frontal. Suplementos de nylon con 1mm, 2mm, 3mm e 4mm (inc.)

**EMBALLAGE**

Boîte avec 10 unités. 2465 grs.

**MATÉRIELS**

Aluminium et zamak

**FIXATION**

Vis inclus

**FINITIONS**

Laqué

**NORMATIF**

EN 1670

**OBSERVATIONS**

Fixation frontal. Cales de nylon avec 1mm, 2mm, 3mm e 4mm (inc.)